

愈合历史伤口，促进社区协和

— 塔可玛中华协和公园简介

2016 年 10 月

塔可玛中华协和公园（协和园），位于美国华盛顿州塔可玛市，为市政府与塔可玛社区协和促进会（协和会）共同筹建，用以纪念 1885 年塔可玛暴力排华事件。

1885 年 11 月 3 日，塔可玛市民，以多年经济萧条，白人工作机会遭受剥夺为借口，由市长及社会各界领袖带头，将市内数百名华人强制驱离，并烧毁其居所。其后三、四十余年，不准任何华人进入塔可玛。这个史称“塔可玛模式”的暴力事件，是美国排华风潮中可耻的一章，也是塔可玛历史上黑暗的一页。塔可玛为当今美国西海岸较大港都之中，唯一没有中国城者，与此一历史事件大有关联。

1993 年 11 月，塔可玛市议会在民间热心人士敦促之下，通过决议案，直面历史，对于暴力排华事件，深表遗憾歉疚，予以谴责，并承诺建造协和园，以资纪念。同时，由民间热心人士筹组的非营利组织“协和会”，亦宣告成立，协助市政府筹款造园，并教育民众，鉴往知来，愈合历史伤口，促进社区协和。

协和园位于柯梦湾畔，距离十九世纪时期塔可玛繁忙的水滨工业区与华人聚居处，只有一箭之遥。根据 2001 年完成的总设计图的规划，公园的建制，采取传统中国式庭园设计，景观优美，意象具足。精心设计的墙垒、假山、植栽、地貌，以对比的配置，创造统和的氛围。每一个造景元素都在诉说着当年华人移民就业徙居的故事。漫步在公园里，仿佛时光倒流，通过建筑造园、图文解说、步道镌刻的提示，一迈步就是一段历史，一回身就是一份感受。

协和园造价约需 3,000 万美元，目前已完成三期建设，主要设施包括海滩、步道、假山、花木、珍珠桥，潮汛池，以及福州亭。福州亭系由塔可玛之姐妹市福州所设计捐建，为传统中国式建筑，堂皇大气，丽致美观，体现福州对于两市情谊之高度珍视，对于协和理念之深表赞同。而规划最为庞大的第四期建设，主要设施包括多元文化馆、悦宾大门、金山亭、仁恕馆、九曲桥、习文馆、鉴知塘等，所需资金大约 2,000 万美元，则尚未到位，急待募集。其中尤以多元文化馆，提供教育、展览、表演、节庆、礼宾、婚礼、聚会等等活动之需，是协和园的中心元素，最为当务之急。

塔可玛市政府与协和会将继续竭尽所能，积极筹款，广求奥援，以完成协和园各项建设。优美的协和园提供了一个殊胜的场域和机会，愈合历史的伤口，培蕴社会的和谐，绽放文化的多元，礼赞人性的大同。“四海之内，皆兄弟也”，子夏的名言，其中蕴涵的仁恕宽和，正是我们一心向往的理想境界，也是我们致力追求的最高目标。

附件：

1. 协和园简介（英文）
2. 协和园剪影
3. 协和园总设计图

TACOMA CHINESE RECONCILIATION PARK

Tacoma, Washington

Fact Sheet (October 2016)

Introduction	The Tacoma Chinese Reconciliation Park is a joint project of the City of Tacoma and the non-profit Chinese Reconciliation Project Foundation and a critical component of the community-led Chinese Reconciliation efforts. The park development was initiated by the City Council, via Resolution No. 32415 adopted on November 30, 1993, aimed to reconcile the 1885 expulsion of Tacoma's Chinese citizens led by the Mayor and civic leaders of that time, to express Tacoma's commitment to end racism and hatred, and to promote a peaceful, multicultural community.																										
Location	The park is located at the southern end of the Ruston Way waterfront park along the Commencement Bay, and is in the proximity of the early Chinese settlement that was burned down during the tragic expulsion. (Address: 1741 N. Schuster Parkway, Tacoma, WA 98403)																										
Size	3.9 acres (donated by the National Guard)																										
Design	According to the Master Site Plan originally developed in 2001 and recently updated in 2014, the park presents a mixture of traditional Chinese scholar's style gardens and beautiful natural waterfront setting. The design creates a variety of spaces carefully defined by walls, mounds, rockwork, landforms, interpretive displays, native and exotic plants, water features, and pavilions and classrooms with Chinese motif. The layout of the park provides a progressive learning environment for the visitors to experience the sojourners' journey to America and their tragic expulsion, to explore opportunities for reconciliation, and to participate in educational, cultural and social functions.																										
Development	<ul style="list-style-type: none"> • Groundbreakings: In 1995 for site preparation and in 2015 for construction. • Phase I (2007 – 2009): The Sojourner's Room, the Path through the Expulsion, the Dragon Mound, the Tiger Mound, the Grotto of the Tides, the String of Pearls Bridge, shoreline protection, trails and pathways, interpretive signs, Chinese artifacts, furnishings, and landscaping and irrigation system. • Phase II (2009 – 2011): The Fuzhou Ting (a Chinese pavilion donated by Tacoma's sister city Fuzhou, China), beach restoration and stabilization, trails and pathways, interpretive signs, furnishings, and landscaping and irrigation system. • Phase III (2015 – 2016): Parking lot, fencing, lighting, interpretive and wayfinding signage, and landscaping and irrigation system improvements. • Phase IV (Unfunded): Multicultural Pavilion, Bay-viewing Terrace and Pond, Zig-zag Bridge, Entrance Gate, Reconciliation Hall, Gold Mountain Pavilion, Tai-Hu stones, classrooms, waterfall, and Chinese garden walls, landscaping. 																										
Budget	<table> <tr> <th colspan="2">Cost</th><th colspan="2">Revenues</th></tr> <tr> <td>Phase I</td><td>\$8.1 M</td><td>State Grants</td><td>\$2.8 M</td></tr> <tr> <td>Phase II</td><td>\$1.0 M</td><td>City Funds</td><td>\$2.8 M</td></tr> <tr> <td>Phase III</td><td>\$0.9 M</td><td>Donations and Contributions</td><td>\$4.4 M</td></tr> <tr> <td>Phase IV (unfunded; educated estimate)</td><td>\$20.0 M</td><td></td><td></td></tr> <tr> <td colspan="2">Total Cost</td><td>Total Revenues</td><td>\$10.0 M</td></tr> </table>			Cost		Revenues		Phase I	\$8.1 M	State Grants	\$2.8 M	Phase II	\$1.0 M	City Funds	\$2.8 M	Phase III	\$0.9 M	Donations and Contributions	\$4.4 M	Phase IV (unfunded; educated estimate)	\$20.0 M			Total Cost		Total Revenues	\$10.0 M
Cost		Revenues																									
Phase I	\$8.1 M	State Grants	\$2.8 M																								
Phase II	\$1.0 M	City Funds	\$2.8 M																								
Phase III	\$0.9 M	Donations and Contributions	\$4.4 M																								
Phase IV (unfunded; educated estimate)	\$20.0 M																										
Total Cost		Total Revenues	\$10.0 M																								
Websites	City of Tacoma: www.cityoftacoma.org/planning (click on "Chinese Reconciliation Park") Chinese Reconciliation Project Foundation: www.TacomaChinesePark.org																										



Chinese Reconciliation Park

和園

- LEGEND**
 (Grayed-out Areas = Completed Features / Colored Areas = Planned Features)
- | | |
|----------------------------|-------------------------------|
| A ENTRANCE PLAZA | N BAY-VIEWING TERRACE |
| B ENTRANCE GATE | O BAY-VIEWING POND |
| C INTERPRETING THE SOJOURN | P GROTTO OF THE TIDES |
| D TING ON THE MOUND | Q WALL |
| E THE SOJOURNER'S ROOM | R EMERGENCY ACCESS TURNAROUND |
| F THE PATH OF EXPULSION | S COBBLE BEACH |
| G RECONCILIATION PAVILION | T PARKING AREA |
| H REFLECTION ROOM | U TING BY THE BAY (OPTIONAL) |
| I MULTICULTURAL PAVILION | V CORRIDOR |
| J CLASSROOMS | W RESTROOM/ STORAGE |
| K ZIG ZAG BRIDGE | X MOON GATE |
| L CELEBRATION ROOM | Y FUZHOU PAVILION |
| M STRING OF PEARLS BRIDGE | |

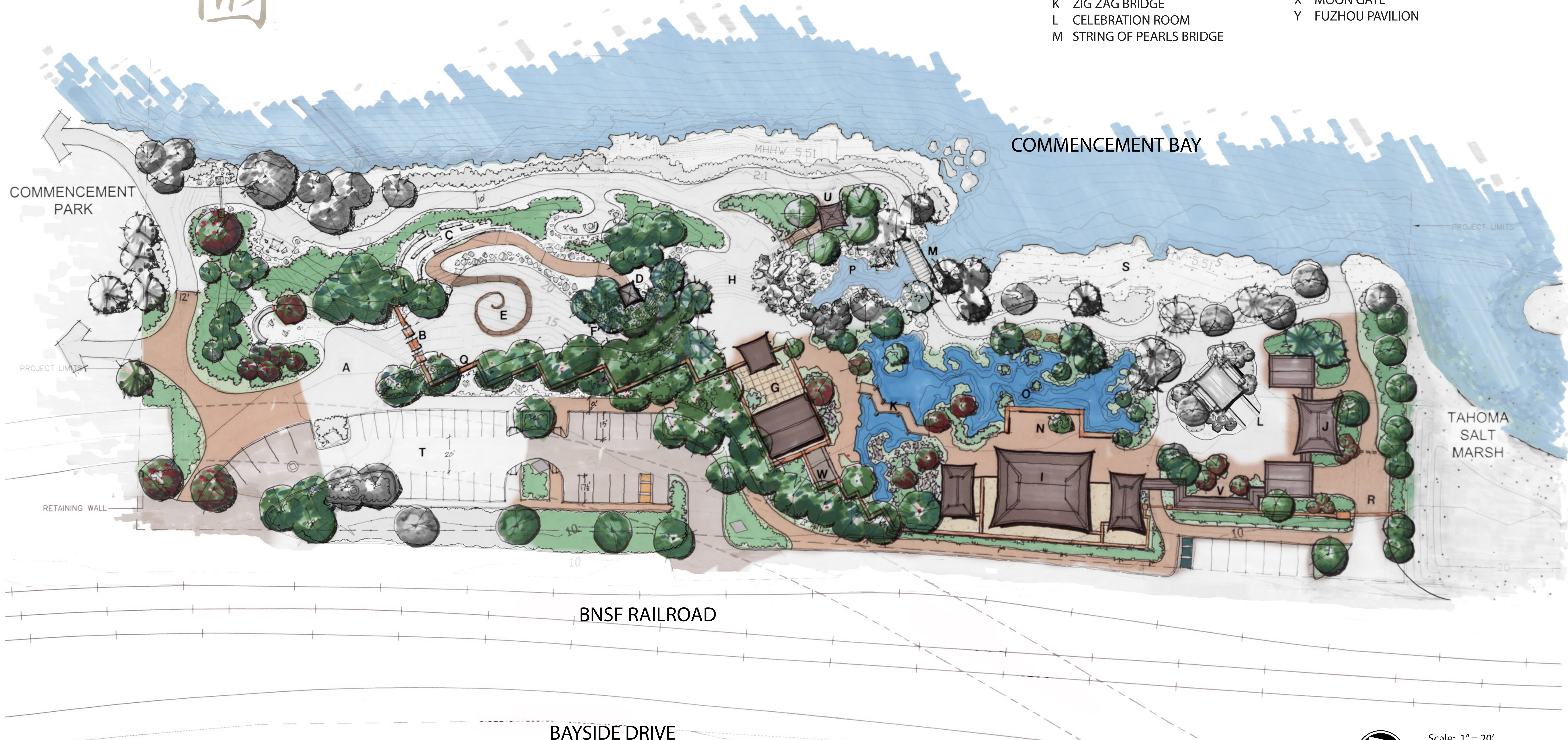

EXHIBIT A: MASTER PLAN
TACOMA CHINESE RECONCILIATION PARK
 CITY OF TACOMA PUBLIC WORKS DEPARTMENT
 THE CHINESE RECONCILIATION PROJECT FOUNDATION

7/1/2014

j.a. brennan
 associates PLLC
 VERTICAL DATUM: N.G.V.D. 1929
 HORIZONTAL DATUM: N.A.D. '83/91'

Scale: 1" = 20'
 0' 20' 40'

IN ASSOCIATION WITH:
JOE WAI ARCHITECTS

HWA GEOSCIENCES INC., GEOTECHNICAL ENGINEERING
 LIN ASSOCIATES, STRUCTURAL ENGINEERING
 MOFFATT & NICHOL, COASTAL ENGINEERING
 PARAMETRIX INC., BIOLOGICAL ASSESSMENT
 ROLLUDA ARCHITECTS
 URS CORPORATION, CIVIL ENGINEERS