



City of Tacoma

## Public Works Engineering Division

**ADDENDUM NO. 2**

**DATE: 3-8-2024**

### **REVISIONS TO:**

**Request for Bids Specification No. PW23-0090F  
TPU S 17th St Court D/E**

### **NOTICE TO ALL BIDDERS:**

This addendum is issued to clarify, revise, add to or delete from, the original specification documents for the above project. This addendum, as integrated with the original specification documents, shall form the specification documents. The noted revisions shall take precedence over previously issued specification documents and shall become part of this contract.

### **REVISIONS TO THE SUBMITTAL DEADLINE:**

The submittal deadline remains the same.

### **REVISIONS TO THE PLANS:**

#### **Revision #1**

Replace the following project plan sheets with the attached plan sheets including Addendum #2 revisions (4 pages/plan sheets):

1. Sheet No. 7 / Sheet DTL-4 of DTL-4
2. Sheet No. 8 / Sheet D-1 of D-1
3. Sheet No. 10 / Sheet C-2 of C-2
4. Sheet No. 12 / Sheet PW-1 of PW-1

### **REVISIONS TO THE SPECIFICATIONS:**

#### **Revision #1**

Replace contract specification section 2-03 with the attached specification section 2-03 (2 pages) noted as a part of this Addendum #2.

#### **Revision #2**

Replace contract specification section 8-40 with the attached specification section 8-40 (4 pages) noted as a part of this Addendum #2.



City of Tacoma

**REVISIONS TO THE PROPOSAL PAGES:**

**Revision #1**

Replace bid proposal in the bid submittal and specifications with the attached bid proposal with Addendum #2 noted at the top of each new bid proposal page.  
(10 pages)

NOTE: Acknowledge receipt of this addendum by initialing the corresponding space as indicated on the signature page. Vendors who have already submitted their bid/proposal may contact the Purchasing Division at 253-502-8468 and request return of their bid/proposal for acknowledgment and re-submittal. Or, a letter acknowledging receipt of this addendum may be submitted in an envelope marked Request for Bids Specification No. PW23-0090F Addendum No. 2. The City reserves the right to reject any and all bids, including, in certain circumstances, for failure to appropriately acknowledge this addendum.

cc: Basel Kitmitto, Public Works Engineering

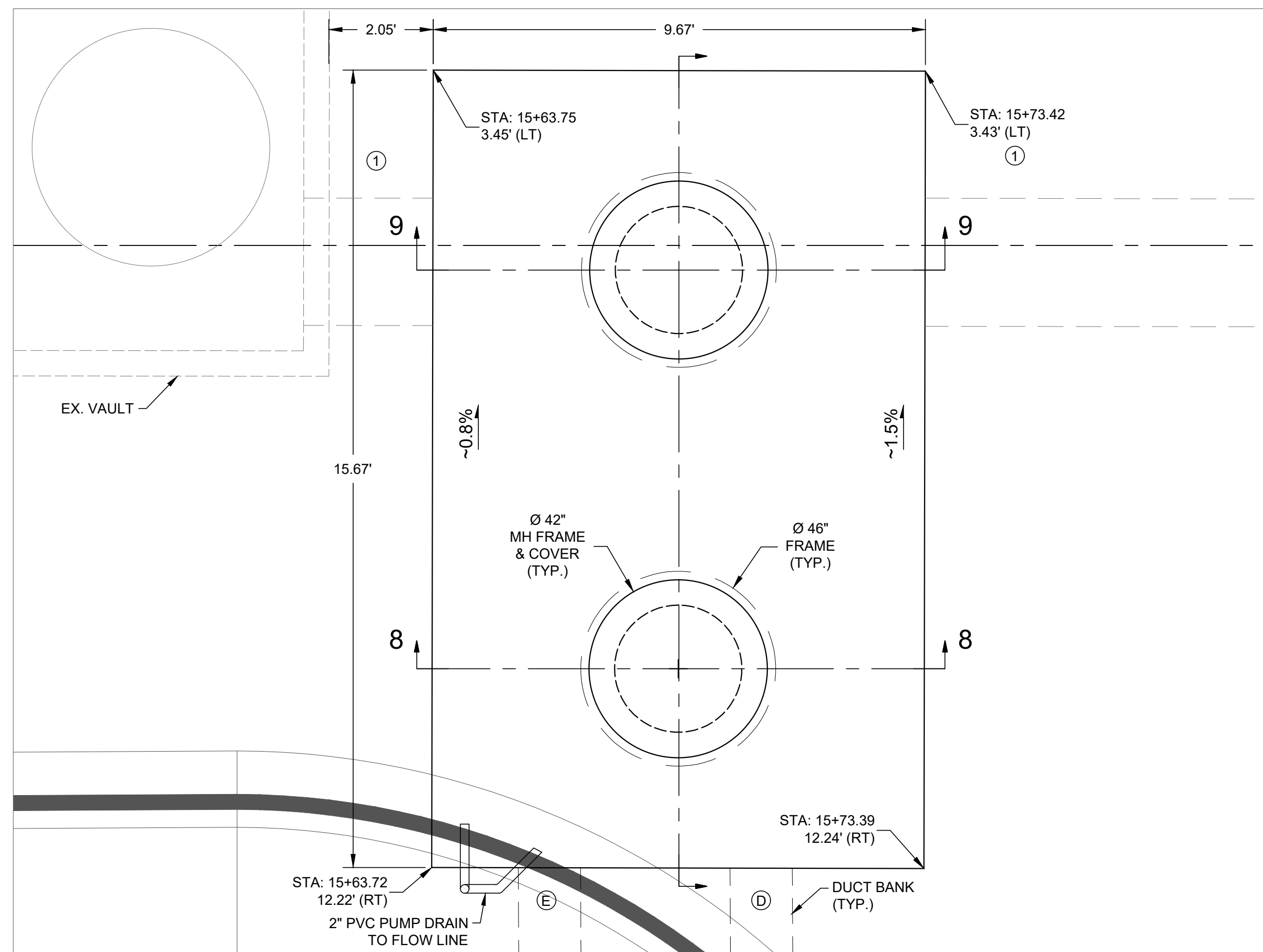

PLAN VIEW  
VAULT 814

1" = 2"

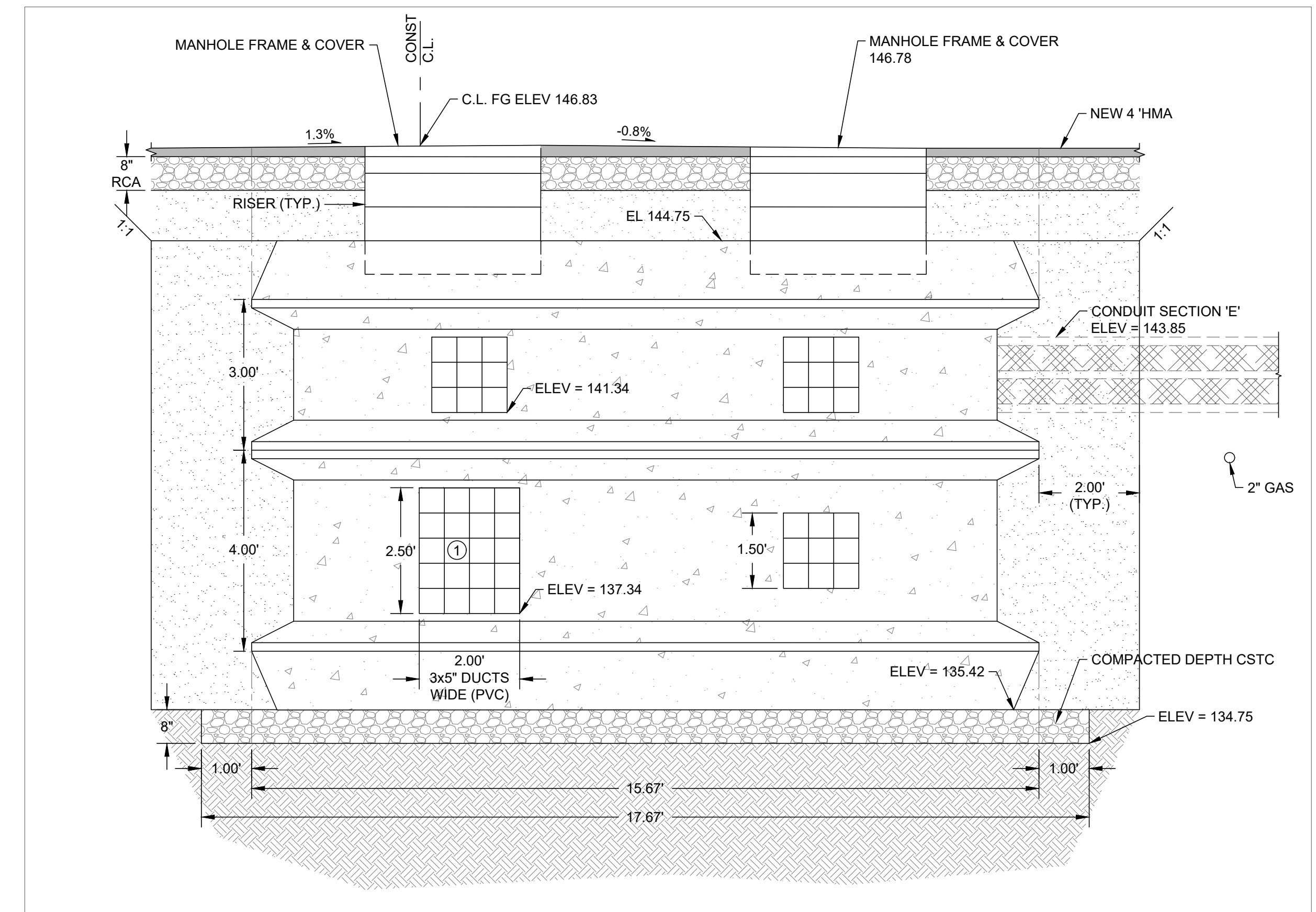

ELEVATION VIEW  
ON VAULT C.L.  
VAULT 814

N.T.S.

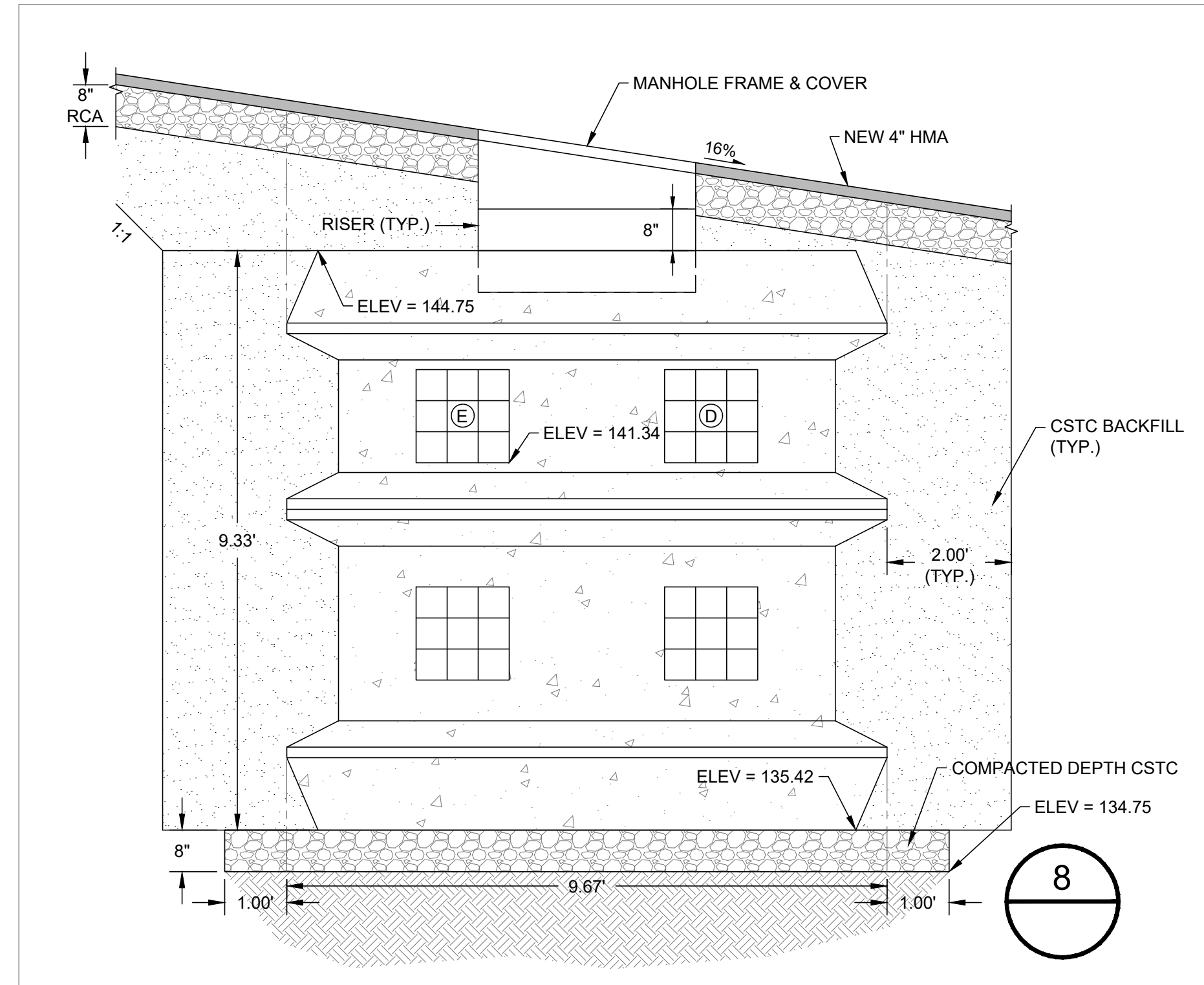

CROSS SECTION 8  
VAULT 814

N.T.S.

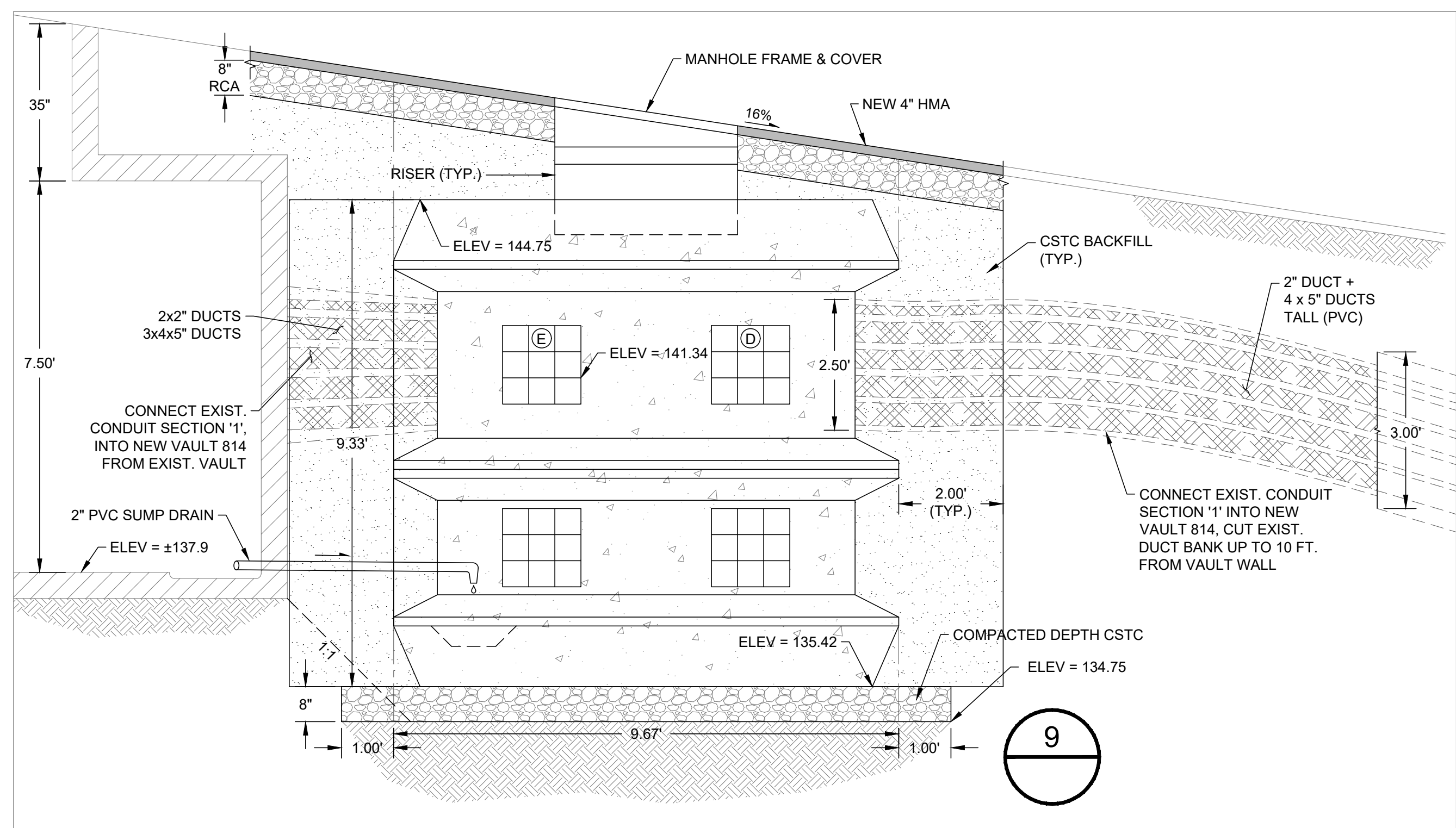

CROSS SECTION 9  
VAULT 814

N.T.S.

NOTE:  
CONTRACTOR SHALL VERIFY WITH  
MANUFACTURER SHOP DRAWINGS FOR  
ACCURATE FOUNDATION ELEVATIONS  
AND EXCAVATION LIMITS

**CALL BEFORE YOU DIG**  
EXISTING UTILITIES ARE SHOWN IN APPROXIMATE LOCATIONS ONLY PER BEST AVAILABLE INFO, AND MAY BE INCOMPLETE. CONTRACTOR SHALL BE RESPONSIBLE FOR LOCATING, POT-HOLING AND AVOIDING ALL EXISTING UTILITIES.  
CALL TWO BUSINESS DAYS BEFORE YOU DIG  
(1-800-424-5555) OR VISIT ONLINE: [www.callbeforeyoudig.org](http://www.callbeforeyoudig.org)

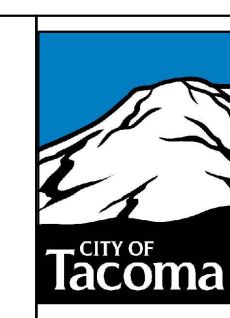

ADDENDUM #2	3/5/24	RDV	FINAL CONSTRUCTION CHECKED	DATE MAR 2024	SCALE 1" = 2"
			BY RDV	DESIGNED RDV	CHECKED DCS
			DATE	DRAWN EJB	PROJECT NAME TPU POWER
			FIELD BOOKS	DRAWING NAME S17TPU-VLT-DTL.DWG	

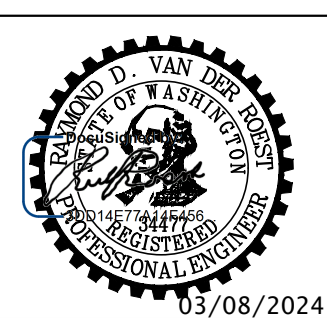

CITY OF TACOMA  
DEPARTMENT OF PUBLIC WORKS

**VAULT DETAIL**

VAULT 814

PWR-01216  
SHEET NO. 7  
SHEET DTL-4 OF DTL-4

DocuSigned by:  
*Jack Meluser*  
ENGINEERING DIVISION MANAGER  
03/08/2024

P:\Design\Projects\CIVIL\_3D\TPU-VLT-DTL.dwg (between Court D-E) Production Drawings\17TPU-VLT-DTL.dwg, 3/8/2024 9:29:06 AM, eboibol

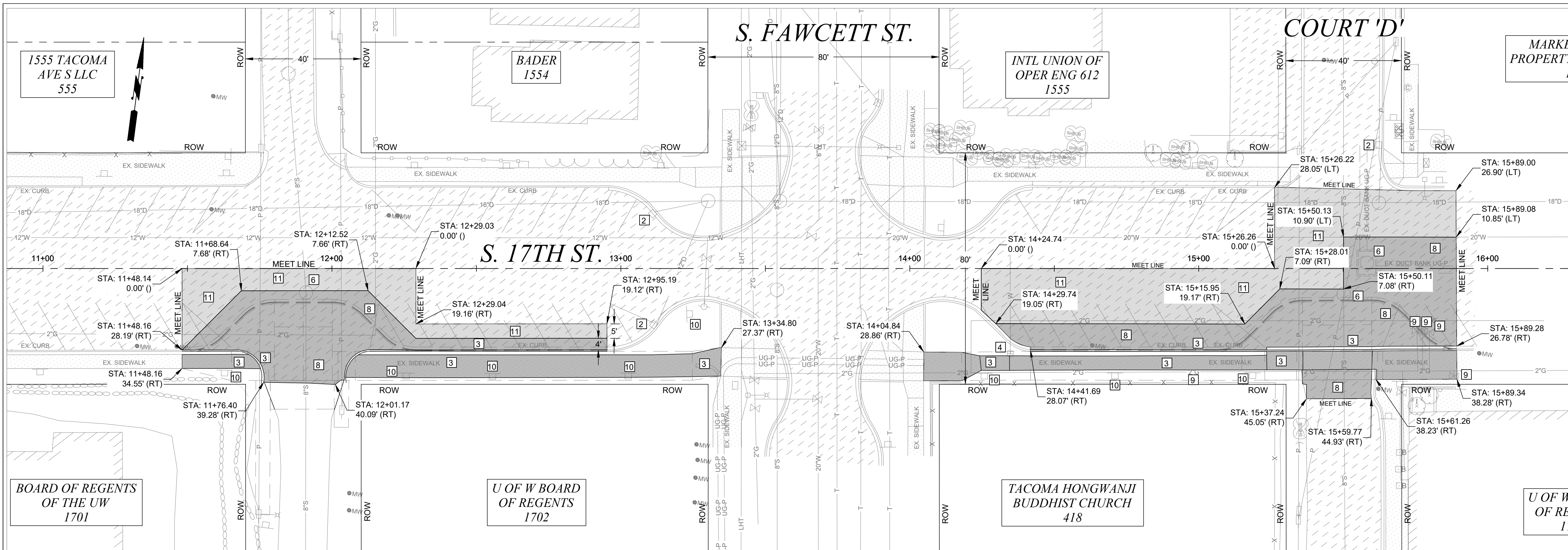

- ### DEMOLITION NOTES
- 1 REMOVE EXISTING SURVEY MONUMENT IN ACCORDANCE WITH WAC 332-120, SUBMIT DEPARTMENT OF NATURAL RESOURCES APPLICATION FOR PERMIT TO REMOVE OR DESTROY A SURVEY MONUMENT. REMOVE EXISTING MONUMENT COMPLETELY TO INSURE SUITABLE INSTALLATION OF NEW GALVANIZED STEEL PIPE TO MINIMUM DEPTHS PER WDOT STD PLAN A-10.30-00.
  - 2 PROVIDE INLET PROTECTION TO EXISTING CATCH BASIN PER SPECIFICATION 8-01 UNTIL REMOVAL OR END OF CONSTRUCTION ACTIVITIES
  - 3 TO BE REMOVED
  - 4 TO BE ADJUSTED BY OTHERS
  - 5 TO BE RELOCATED BY OTHERS
  - 6 ADJUST TO GRADE PER SPECIFICATION 7-05
  - 7 ADJUST EXISTING VALVE PER CITY OF TACOMA STANDARD SU-37
  - 8 REMOVE PAVEMENT PER SPECIFICATION 2-14
  - 9 TO BE REMOVED BY PUGET SOUND ENERGY (PSE)
  - 10 REMOVE AND SALVAGE SIGN AND POST, TO BE RELOCATED PER PLANS AND AS DIRECTED BY ENGINEER
  - 11 2" ASPHALT GRIND

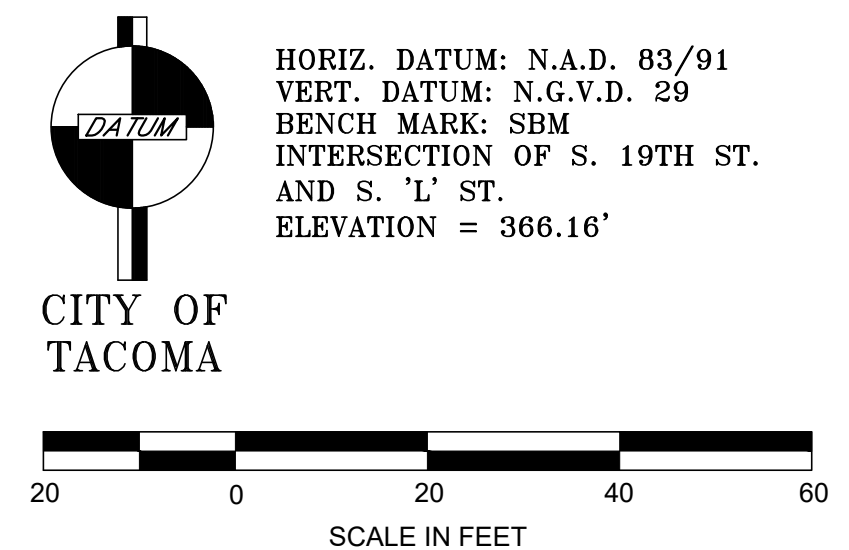

<b>CALL BEFORE YOU DIG</b> EXISTING UTILITIES ARE SHOWN IN APPROXIMATE LOCATIONS ONLY PER BEST AVAILABLE INFO, AND MAY BE INCOMPLETE. CONTRACTOR SHALL BE RESPONSIBLE FOR LOCATING, POTHOLES AND AVOIDING ALL EXISTING UTILITIES. CALL TWO BUSINESS DAYS BEFORE YOU DIG (1-800-424-5555) OR VISIT ONLINE: www.callbeforeyoudig.org		ADDENDUM #2	3/5/24	RDV	FINAL CONSTRUCTION CHECKED	DATE MAR 2024	SCALE 1" = 20'		CITY OF TACOMA DEPARTMENT OF PUBLIC WORKS		<b>DEMOLITION PLAN</b> S. 17TH TACOMA POWER INFRASTRUCTURE CT. D & E S. 17TH ST. FROM COURT D & E	PWR-01216 SHEET NO. 8 SHEET D-1 OF D-1
		NO	REVISION	DATE	APPD	BY RDV	DESIGNED RDV		CHECKED DCS	DRAWN EJB		

P:\Design\Projects\CIVIL 3D\TPU-D\17th Tacoma Power Infrastructure (between Court D-E)\Production Drawings\17TPU-D.dwg, 3/8/2024 11:19:25 AM, eholbol



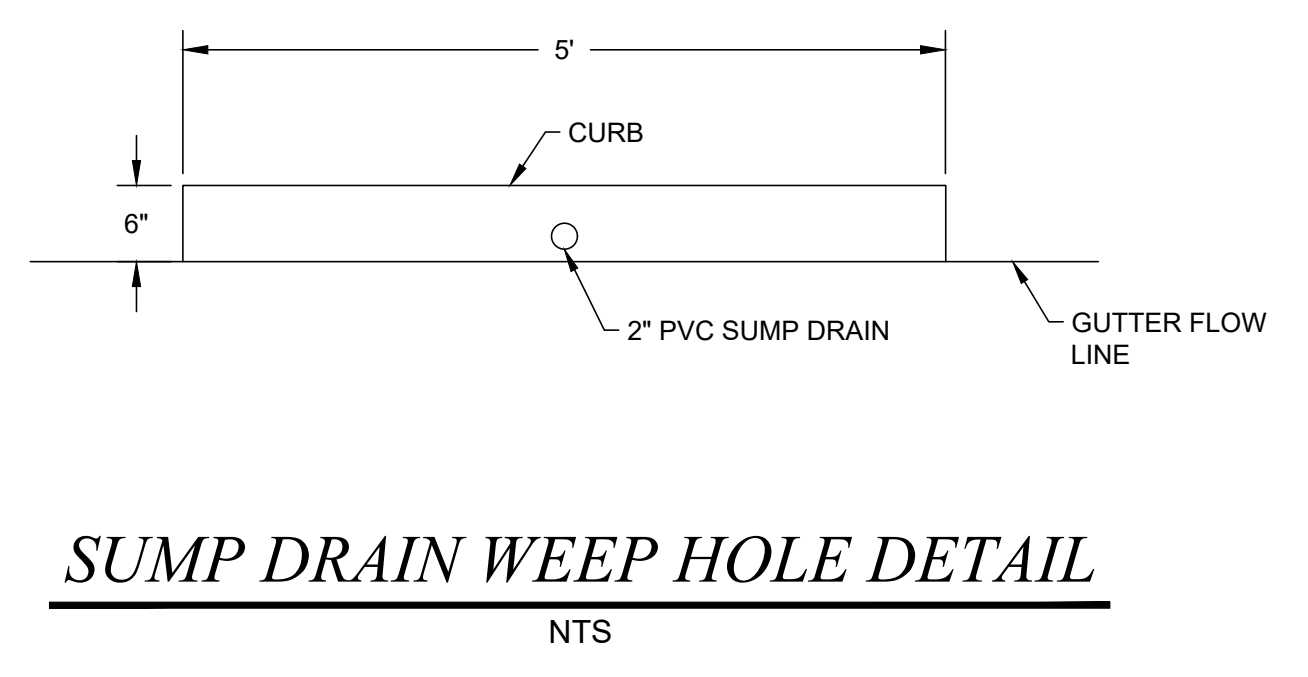
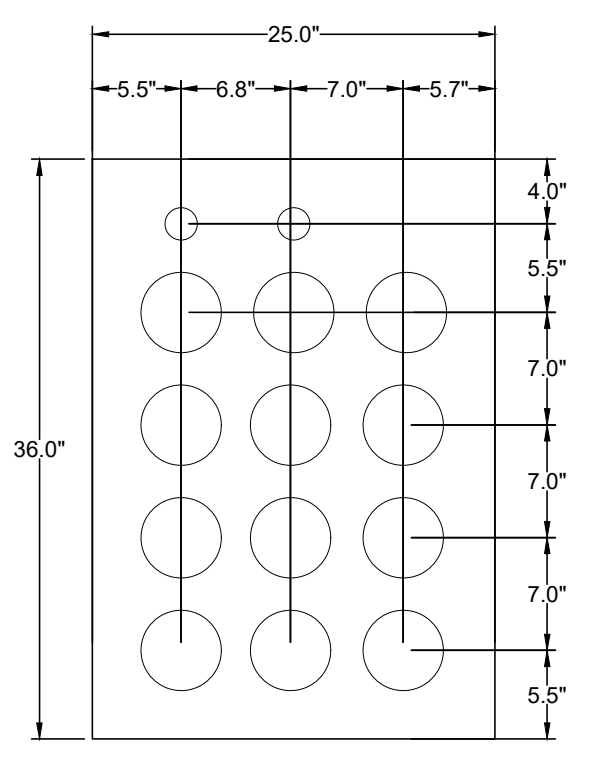
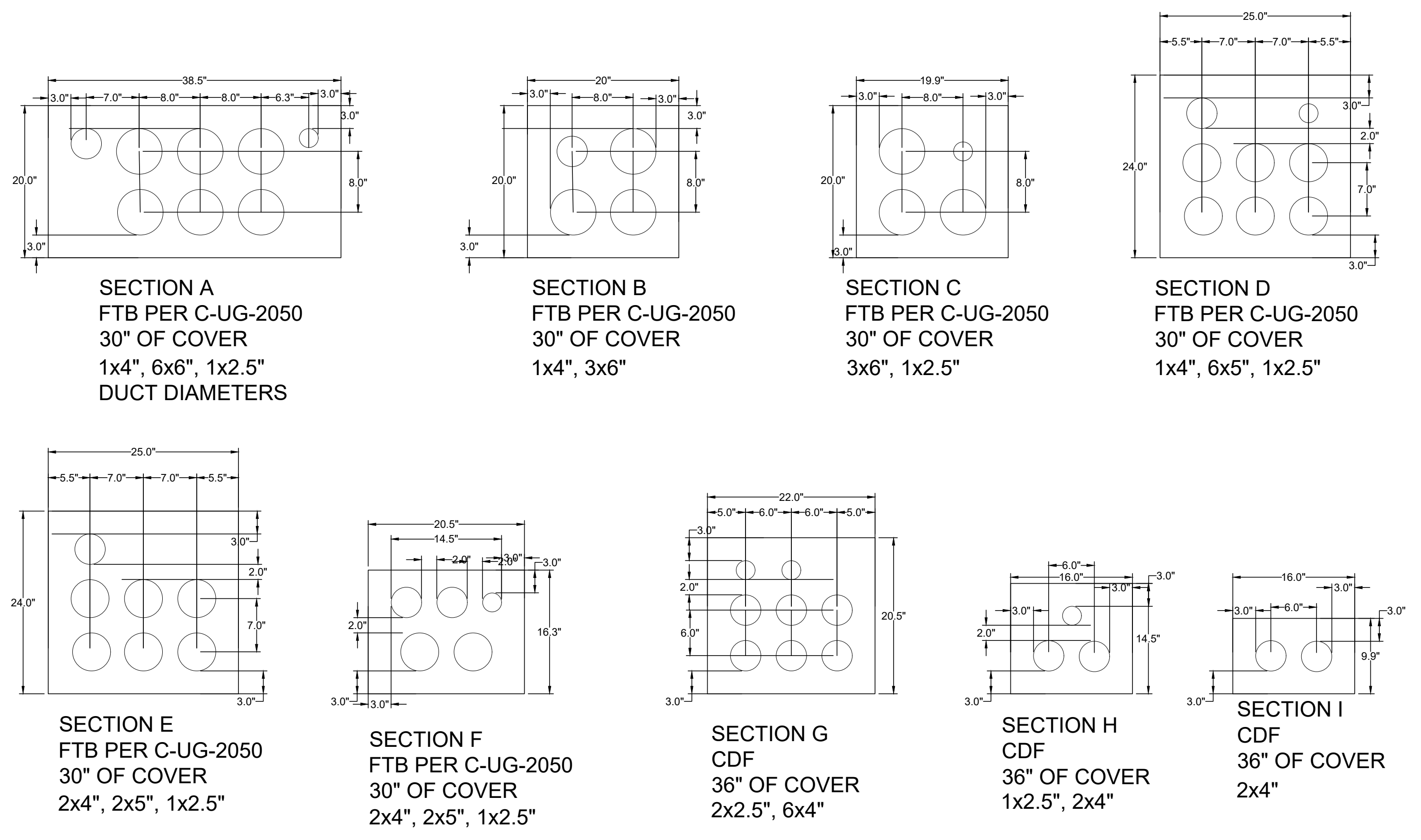
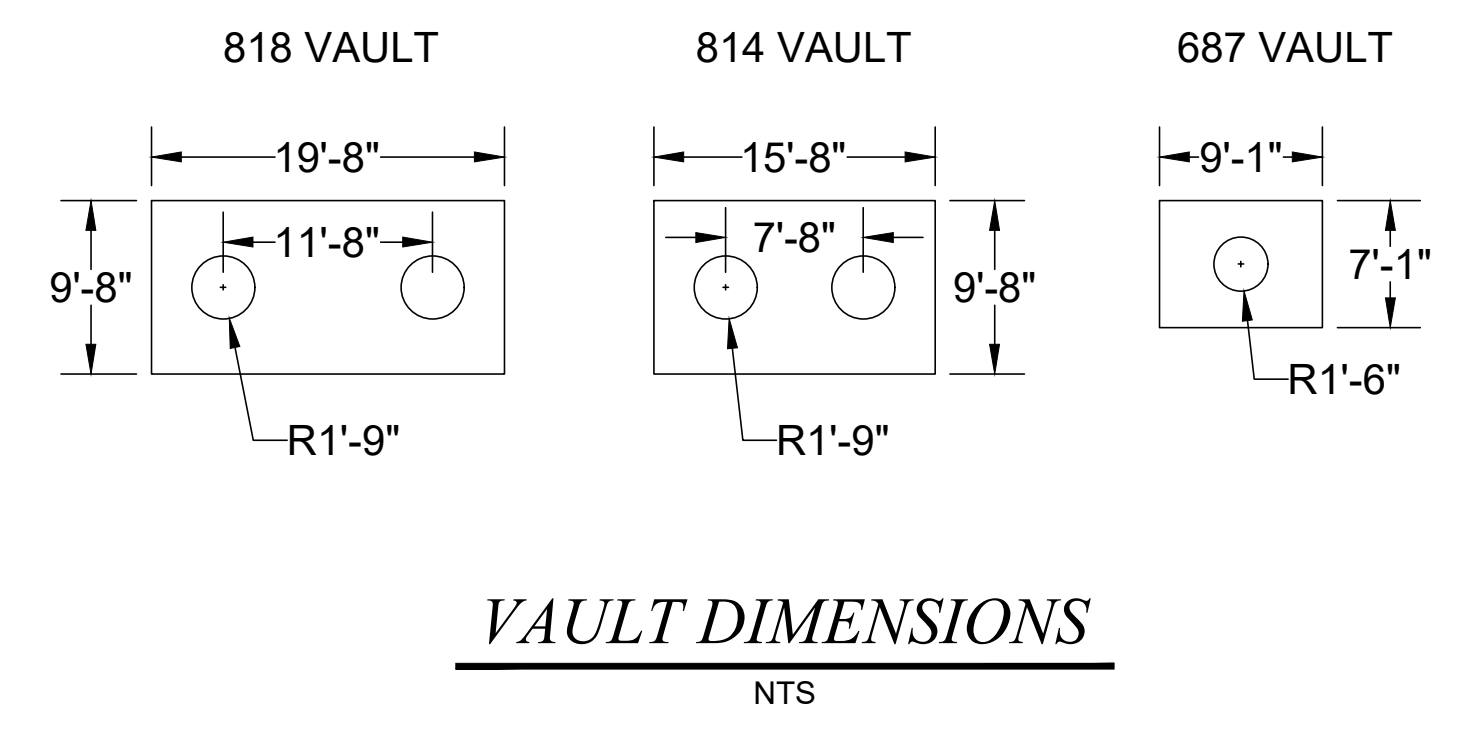
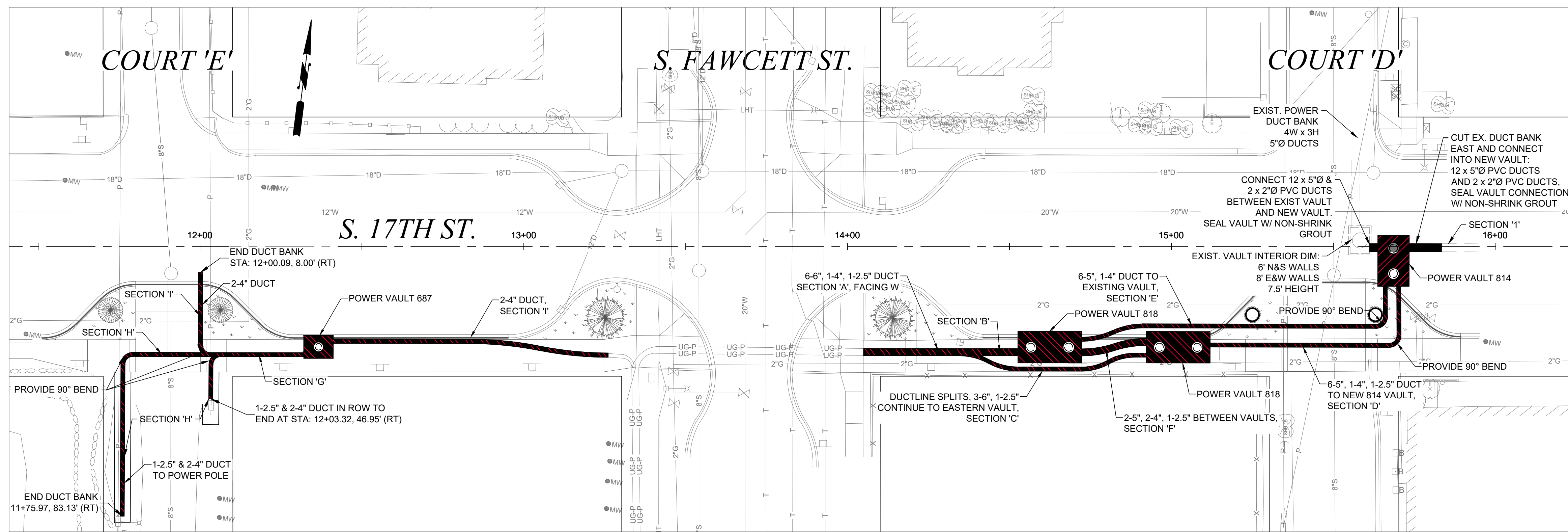

**NOTE:**

- BENDING RADIUS = 36" MIN. TO DUCT CENTERLINE, TYPICAL
- DIMENSIONS IN INCHES, TYPICAL
- OUTSIDE DUCTBANK DIMENSIONS EQUAL THE LIMITS OF THE FTB OR CDF PLACEMENT, BACKFILL WITH CSTC

**CITY OF TACOMA**

HORIZ. DATUM: N.A.D. 83/91  
 VERT. DATUM: N.G.V.D. 29  
 BENCH MARK: SBM  
 INTERSECTION OF S. 19TH ST.  
 AND S. 'L' ST.  
 ELEVATION = 366.16'

**CALL BEFORE YOU DIG**  
 EXISTING UTILITIES ARE SHOWN IN APPROXIMATE LOCATIONS ONLY PER BEST AVAILABLE INFO, AND MAY BE INCOMPLETE. CONTRACTOR SHALL BE RESPONSIBLE FOR LOCATING, POTHOLES AND AVOIDING ALL EXISTING UTILITIES.  
 CALL TWO BUSINESS DAYS BEFORE YOU DIG (1-800-424-5555) OR VISIT ONLINE: www.callbeforeyoudig.org

**CITY OF TACOMA**

ADDENDUM #2

3/5/24 RDV

FINAL CONSTRUCTION CHECKED

DATE: MAR 2024 SCALE: 1" = 20'

DESIGNED: RDV CHECKED: DCS

DRAWN: EJB PROJECT NAME: TPU POWER

FIELD BOOKS: DRAWING NAME: S17TPU-PW.DWG

DATE: 03/08/2024

**CITY OF TACOMA DEPARTMENT OF PUBLIC WORKS**

**POWER PLAN**

S. 17TH TACOMA POWER INFRASTRUCTURE CT. D & E  
 S. 17TH ST. FROM COURT D & E

PWR-01216

SHEET NO. 12  
 SHEET PW-1 OF PW-1

1  
2 **2-03 ROADWAY EXCAVATION AND EMBANKMENT**

3 **(\*\*\*\*\*)**

4  
5 **2-03.1 Description**

6 *The last sentence of the first paragraph is deleted.*

7  
8 **2-03.3 Construction Requirements**

9 *This section is supplemented with the following:*

10  
11 All roadway excavation shall be handled, hauled, and disposed of as contained-in determination  
12 (CID) contaminated material. The Contractor shall haul and dispose of all contaminated soil  
13 material excavated from the Project site in accordance with the Contract, Plans, and  
14 Specifications to LRI Landfill, located at 30919 Meridian Street East, Graham, WA 98338 in  
15 accordance with Special Provisions Section 2-17. The Contractor shall not include the cost of  
16 the disposal fees in the bid item. The City of Tacoma will pay the disposal fees directly to LRI.

17  
18 **All soil from roadway excavation activities will be disposed of off site and shall be**  
19 **considered unsuitable fill material.**

20  
21 **2-03.3(5) Slope Treatment**

22 *This section is deleted.*

23  
24 **2-03.3(19) Removal of Pavement, Sidewalks, Curbs, and Gutters**

25 *This section is deleted.*

26  
27 *Section 2-03.3 is supplemented with the following:*

28  
29 **2-03.3(20) Field Adjustment**

30 **(\*\*\*\*\*)**

31  
32 Field adjustment involves adjustments to horizontal or vertical alignments, or vault elevations,  
33 that are shown in the plans or directed by the Engineer and will be performed as needed, by the  
34 Contractor, to address issues with drainage, utility vault construction, street crowning, cross  
35 slopes, curb ramps, and connections to existing grades for the finished product. The Contractor  
36 and the Engineer shall collaborate on field adjustment. All grade checking needed to complete  
37 the field adjustments shall be provided by the Contractor. The Contractor shall continue work,  
38 during the field adjustment time, in unaffected areas of the Project, in accordance with the Plans  
39 and Specifications. Some localized delay is inherent in this process, and the contractor shall be  
40 prepared to collaborate and move crews on to other work locations. For each field adjustment  
41 the City of Tacoma shall pay the Contractor by Force Account in accordance with Section 1-  
42 09.6. The contractor shall not be entitled to additional compensation due to delays from field  
43 adjustments.

44  
45 **2-03.5 Payment**

46 *This section is supplemented with the following:*

47  
48 "Roadway Excavation - CID Contaminated, Incl. Haul", per cubic yard.

1 The unit Contract price per cubic yard for “Roadway Excavation - CID Contaminated, Incl. Haul”  
2 shall be full compensation for all costs incurred for excavating, loading, disposal and haul of  
3 contained-in determination (CID) contaminated material to LRI Landfill. The Contractor shall not  
4 include the cost of the disposal fees in the bid item. The City of Tacoma will pay the cost of the  
5 disposal fees directly to LRI.

6  
7 “Unsuitable Foundation Excavation - CID Contaminated, Incl. Haul”, per cubic yard

8  
9 The unit Contract price per cubic yard for “Unsuitable Foundation Excavation - CID  
10 Contaminated, Incl. Haul” shall be full compensation for all costs incurred for excavating below  
11 subgrade per Section 2-03.3(14)E, loading, disposal and haul of contained-in determination  
12 (CID) contaminated material to LRI Landfill. The Contractor shall not include the cost of the  
13 disposal fees in the bid item. The City of Tacoma will pay the cost of the disposal fees directly  
14 to LRI.

15  
16 “Field Adjustment”, by Force Account

17  
18  
19  
20

**END OF SECTION**



1  
2  
3  
4  
5  
6  
7  
8  
9  
10  
11  
12  
13  
14  
15  
16  
17  
18  
19  
20  
21  
22  
23  
24  
25  
26  
27  
28  
29  
30  
31  
32  
33  
34  
35  
36  
37  
38  
39  
40  
41  
42  
43  
44  
45  
46  
47

**8-40 POWER UTILITY WORK**  
**(\*\*\*\*\*)**

**8-40.1 Description**

This work shall consist of furnishing and installing power utility vaults, related structure excavation and trench excavation, installation of power duct banks with pull lines, and flowable thermal backfill placement (FTB). The City of Tacoma Power Utility crews shall install power cables and wiring in coordination with the Contractor.

**8-40.2 Materials**

Material Standards are according to Tacoma Power Standards. Applicable standards are included in the Appendix of these Contract Provisions.

Power Vaults shall be installed in accordance with C-UG-1500. The Vaults available from some local suppliers may be slightly bigger in size, and can be 5000 lbs heavier. The Contractor shall be responsible to investigate the size and weight of vault components and provide shop drawings at least 5 days prior to the start of installation. The City of Tacoma may make adjustments to vault detail sheets for excavation limits and foundation elevations upon receiving shop drawings.

Electronic Tracer Ball: 3M EMS 1402 Electronic Tracer Ball or Tacoma Power approved equivalent.

**8-40.3 Construction Requirements**

Tacoma Power Utility standards as included in the appendix shall govern. Otherwise trench excavation, structure excavation, and installation of conduits and structures shall be in accordance with Sections 2-09, 7-05, and 7-08, 8-20, 9-29 while Section 8-40 shall govern.

Power Duct banks, Power Vaults, and trench excavation shall be in accordance with the Plans and Specifications, and Tacoma Power Utility standards. All conduits and ducts shall be installed with pull lines.

**Vaults:**

The Contractor shall install Power Utility Vaults in accordance with the Plans, Tacoma Power Standards, and these Special Provisions. Construct a 8-inch compacted thickness, level foundation pad under the entire vault, extending 1-foot out from the vault base. The foundation pad shall be constructed with crushed surfacing top course (CSTC) compacted to at least 95% of maximum density in accordance with Section 4-04.3. The Contractor shall adjust the lids and covers to finished grade, and install a single 2" sump drain for pump connection at each vault from existing knockout through the new curb to empty to the gutter flow line. A sump drain detail is included in the Plans.

1 Where new duct banks are connected to a new vault per the Plans, the Contractor shall use the  
2 vault knock-outs to make an opening and extend the ducts including pull-lines into the vault.  
3 The opening shall be cemented and sealed with non-shrink Grout Type 2 or Mortar Type 3 per  
4 WSDOT Standard Specifications Sections 9-20.3(2) and 9-20.4(4).

5  
6 **Structure Excavation, Vaults, Trenches, and Duct Banks:**

7  
8 The Contractor shall haul and dispose of all contaminated soil material excavated from the  
9 Project site in accordance with the Contract, Plans, and Specifications to LRI Landfill, located at  
10 30919 Meridian Street East, Graham, WA 98338 in accordance with Special Provisions Section  
11 2-17.

12  
13 Structure Excavation Class B horizontal paylimits shall coincide with duct bank dimensions  
14 including the CDF or FTB volume. The lower paylimits shall be the bottom of CSTC foundation  
15 under a vault and coincide with the bottom of a duct bank including the CDF or FTB volume.  
16 The upper trench excavation pay limits shall be the existing ground surface or the bottom of any  
17 sidewalk or other pavement removal.

18  
19 Structure Excavation for vaults shall be in accordance with Sections 2-09, and shall be included  
20 in the quantity for "Structure Excavation Class B Incl. Haul \_\_\_", per cubic yard. **Horizontal**  
21 **paylimits for Structure Excavation for Vaults shall be at 2 foot horizontal distance from**  
22 **the outside of the vault wall.**

23  
24 Power duct banks shall be encased in Flowable Thermal Backfill (FTB) or CDF to a depth in  
25 accordance with the Plans and these Special Provisions. The outside dimensions of each duct  
26 bank section as shown in the Plans define the limits for FTB or CDF placement. The remainder  
27 of the back fill shall be crushed surfacing top course (CSTC). Install an Electronic Tracer Ball in  
28 the topmost, centermost duct at locations where newly built conduit banks do not terminate into  
29 a vault.

30  
31 **Connect Existing Ductbank into new Vault**

32  
33 The Contractor shall connect an existing duct-bank into a new vault where shown per the Plans.  
34 At these locations the Contractor shall cut the existing duct-bank upto 10 feet from the proposed  
35 vault wall or as necessary for installing the new vault and extending the ducts into the vault.

36  
37 The final construction scenario will be dependent on the actual depth of the conduits within the  
38 ductbank, and the Contractor shall field adjust the design detail in coordination with the  
39 Engineer. This may involve reversing vault top and bottom section, installing conduit  
40 connections into the vault wall, adjusting the vault foundation elevation, or installing PVC bends  
41 in conduits to line up with the connection points. The City will pay for any field adjustments by  
42 force account under "Field Adjustment" in accordance with these Special Provisions and Section  
43 2-03.

44  
45 The City will pay for any changes that result in additional Vault customization that is not shown  
46 per Plans for new or existing vaults under "Minor Change" by Force Account.

1 **8-40.4 Measurement**

2  
3 “Connect Existing Ductbank into new Vault”, shall be measured per each new vault wall where a  
4 ductbank connection is constructed into the vault including all duct extensions.

5  
6 Power Utility Vault shall be measured per each vault furnished and installed in accordance with  
7 the Plans and Specifications, and Tacoma Power Utility standards.

8  
9 “\_\_\_ Conduit Bank “ shall be measured per linear foot along the alignment of the power conduit  
10 bank trench.

11  
12 Flowable Thermal Backfill (FTB) and CDF shall be included in the measurement per linear foot  
13 for “\_\_\_ Conduit Bank”.

14  
15 “Electronic Tracer Ball” shall be measured per each tracer ball installed in accordance with  
16 these Special Provisions and TPU Power Standards.

17  
18 “Structure Excavation Class B Incl. Haul\_\_\_” shall be measured per cubic yard in place before  
19 excavation to the paylimits per Section 8-40.3.

20  
21 **8-40.5 Payment**

22  
23 “Connect Existing Ductbank into new Vault”, per Each

24  
25 The Contract unit price per each for “Connect Existing Ductbank into new Vault” shall be full  
26 compensation for all labor, equipment and materials to cut and remove and dispose of the  
27 existing duct bank as necessary per Plans and Specifications, to make an adequate opening in  
28 the vault wall, and to connect and extend existing ducts with new duct lengths, including pull  
29 lines, into the new vault per the TPU Power Standards, and to cement and seal the opening per  
30 the Special Provisions and Specifications.

31  
32 The City will pay for any field adjustments by force account under “Field Adjustment” in  
33 accordance with these Special Provisions and Section 2-03.

34  
35 The City will pay for any changes that result in additional Vault customization that is not shown  
36 per Plans for new or existing vaults under “Minor Change” by Force Account.

37  
38 “Power Utility \_\_\_ Vault” per Each

39  
40 The Contract price per each for Power Utility \_\_\_ Vault shall be full compensation for all labor,  
41 tools, equipment, and materials to furnish and install the complete vault, including single 2”  
42 sump line, to cement and seal duct connections, and to adjust the lids and covers to finished  
43 grade all in accordance with the Plans, Special Provisions and Specifications.

44  
45 “Power Utility 818 Vault”, per each

46  
47 “Power Utility 814 Vault”, per each

48  
49 “Power Utility 687 Vault”, per each

1  
2 “\_\_\_ Conduit Bank”, per linear foot

3  
4 The Contract price per linear foot for “\_\_\_ Conduit Bank” shall be full compensation for all labor,  
5 tools, equipment, and materials to install the power conduit bank including pull lines and FTB,  
6 and to construct connections into the vaults, all in accordance with TPU Power Standards, the  
7 Plans, Special Provisions and Specifications. The outside dimensions of each duct bank section  
8 as shown in the Plans define the pay-limits for FTB.

9  
10 “Section A Conduit Bank”, per linear foot

11  
12 “Section B Conduit Bank”, per linear foot

13  
14 “Section C Conduit Bank”, per linear foot

15  
16 “Section D Conduit Bank”, per linear foot

17  
18 “Section E Conduit Bank”, per linear foot

19  
20 “Section F Conduit Bank”, per linear foot

21  
22 “Section G Conduit Bank”, per linear foot

23  
24 “Section H Conduit Bank”, per linear foot

25  
26 “Section I Conduit Bank”, per linear foot

27  
28 “Electronic Tracer Ball”, per Each

29  
30 The Contract price per each for Electronic Tracer Ball shall be full compensation for all labor,  
31 tools, equipment, and materials to furnish and install the electronic tracer ball.

32  
33  
34 **END OF SECTION**

35

# ADDENDUM #2

## BID PROPOSAL

SPECIFICATION NO. PW23-0090F ADDENDUM #2

### TPU S 17th Street Court D/E Project

The undersigned hereby certifies that he/she has examined the location and construction details of work as outlined on the Plans and Specifications for Project No. **PWR-01216** and has read and thoroughly understands the Plans and Specifications and contract governing the work embraced in this improvement and the method by which payment will be made for said work, and hereby proposes to undertake and complete the work embraced in this improvement in accordance with said Plans, Specifications and contract and at the following schedule of rates and prices:

- NOTE:
1. Unit prices of all items, all extensions and total amount of bid should be shown. Show unit prices in figures only.
  2. The notations below the item numbers refer to the specification section where information may be found regarding each contract item. These notations are intended only as a guide and are not warranted to refer to all specification sections where information may be found.

The bid items are grouped as follows:

**Group R: Roadway Bid Items**

**Group P: Power Utility Bid Items**

**Group L: Lump Sum Bid Items**

Summarize totals as indicated on the pages that follow below:

Contractor's Name: \_\_\_\_\_  
Specification Number: PW23-0090F ADDENDUM #2  
TPU S 17th Street Court D/E Project

# ADDENDUM #2

**Group-R: TPU S 17th Street Court D/E Project  
Roadway Bid Items R-1 through R-28  
Specification No. PW23-0090F ADDENDUM #2**

ITEM NO.	ITEM DESCRIPTION	ESTIMATE QUANTITY	UNIT PRICE	TOTAL AMOUNT
R- 1 2-02	Test Hole, per linear foot	100 LF	\$ _____	\$ _____
R- 2 2-03	Roadway Excavation - CID Contaminated, Incl. Haul, per cubic yard	230 CY	\$ _____	\$ _____
R- 3 2-03	Unsuitable Foundation Excavation - CID Contaminated, Incl. Haul, per cubic yard	20 CY	\$ _____	\$ _____
R- 4 2-09	Structure Excavation Class B Incl. Haul - CID Contaminated, per cubic yard	730 CY	\$ _____	\$ _____
R- 5 2-09	Shoring Class B, per square foot	3,320 SF	\$ _____	\$ _____
R- 6 2-09	Extra Excavation Class B, CID Contaminated, per cubic yard	100 CY	\$ _____	\$ _____
R- 7 2-14	Remove Existing Pavement, Type I, Class C6, per square yard	270 SY	\$ _____	\$ _____
R- 8 2-14	Remove Existing Pavement, Type I, Class CA, per square yard	530 SY	\$ _____	\$ _____
R- 9 2-15	Remove Curb, per linear foot	293 LF	\$ _____	\$ _____
R- 10 4-04	Crushed Surfacing Top Course, per ton	1,000 TN	\$ _____	\$ _____

Contractor's Name: \_\_\_\_\_

Specification Number: PW23-0090F ADDENDUM #2

# ADDENDUM #2

ITEM NO.	ITEM DESCRIPTION	ESTIMATE QUANTITY	UNIT PRICE	TOTAL AMOUNT
R- 11 4-04	Recycled Concrete Aggregate, per ton	150 TN	\$ _____	\$ _____
R- 12 5-04	Planing Bituminous Pavement, per square yard	520 SY	\$ _____	\$ _____
R- 13 5-04	Temporary Pavement Patch, per ton	20 TN	\$ _____	\$ _____
R- 14 5-04	Fiber Reinforced HMA CL 1/2" PG 58H-22, per ton	160 TN	\$ _____	\$ _____
R- 15 7-05	Adjust Existing Manhole, Furnish New Frame and Cover, per each	2 EA	\$ _____	\$ _____
R- 16 8-02	PSIPE Accolade elm, per each	2 EA	\$ _____	\$ _____
R- 17 8-02	PSIPE hardy rubber tree, per each	2 EA	\$ _____	\$ _____
R- 18 8-02	PSIPE American Yellowwood, per each	2 EA	\$ _____	\$ _____
R- 19 8-04	Cement Conc. Traffic Curb and Gutter, per linear foot	350 LF	\$ _____	\$ _____
R- 20 8-06	Cement Conc. Driveway Entrance, per square yard	180 SY	\$ _____	\$ _____
R- 21 8-14	Cement Conc. Sidewalk, per square yard	320 SY	\$ _____	\$ _____

Contractor's Name: \_\_\_\_\_

Specification Number: PW23-0090F ADDENDUM #2

Group R, Page 2 of 3

# ADDENDUM #2

ITEM NO.	ITEM DESCRIPTION	ESTIMATE QUANTITY	UNIT PRICE	TOTAL AMOUNT
R- 22 8-15	Quarry Spalls, per ton	10 TN	\$ _____	\$ _____
R- 23 8-20	Install Conduit, 2-inch Dia. PVC Schedule 80, with Pull Line, per linear foot	330 LF	\$ _____	\$ _____
R- 24 8-20	Install Type 1 Junction Box, per each	4 EA	\$ _____	\$ _____
R- 25 8-22	Paint Line, per linear foot	400 LF	\$ _____	\$ _____

**SubTotal, Group R**  
**Unit Bid Item Nos. R-1 through R-25** \$ \_\_\_\_\_ (1)

R 26 2-03	Field Adjustment	Force Account	<u>Estimated</u>	\$ <u>10,000.00</u> (2)
R 27 1-04.4	Minor Change	Force Account	<u>Estimated</u>	\$ <u>10,000.00</u> (3)
R 28 8-01	Dewatering	Force Account	<u>Estimated</u>	\$ <u>10,000.00</u> (4)

**Total, Group R** **(1)+(2)+(3)+(4)** \$ \_\_\_\_\_ (5)

Contractor's Name: \_\_\_\_\_

Specification Number: PW23-0090F ADDENDUM #2



# ADDENDUM #2

**Group-P: TPU S 17th Street Court D/E Project**  
**Power Bid Items P-1 through P-14**  
**Specification No. PW23-0090F ADDENDUM #2**

ITEM NO.	ITEM DESCRIPTION	ESTIMATE QUANTITY	UNIT PRICE	TOTAL AMOUNT
P- 1 8-40	Power Utility 818 Vault, per each	2 Each	\$ _____	\$ _____
P- 2 8-40	Power Utility 814 Vault, per each	1 Each	\$ _____	\$ _____
P- 3 8-40	Power Utility 687 Vault, per each	1 Each	\$ _____	\$ _____
P- 4 8-40	Section A Conduit Bank, per linear foot	35 Lin. Ft.	\$ _____	\$ _____
P- 5 8-40	Section B Conduit Bank, per linear foot	15 Lin. Ft.	\$ _____	\$ _____
P- 6 8-40	Section C Conduit Bank, per linear foot	55 Lin. Ft.	\$ _____	\$ _____
P- 7 8-40	Section D Conduit Bank, per linear foot	80 Lin. Ft.	\$ _____	\$ _____
P- 8 8-40	Section E Conduit Bank, per linear foot	110 Lin. Ft.	\$ _____	\$ _____
P- 9 8-40	Section F Conduit Bank, per linear foot	22 Lin. Ft.	\$ _____	\$ _____

Contractor's Name: \_\_\_\_\_

Specification Number: PW23-0090F ADDENDUM #2

# ADDENDUM #2

ITEM NO.	ITEM DESCRIPTION	ESTIMATE QUANTITY	UNIT PRICE	TOTAL AMOUNT
P- 10 8-40	Section G Conduit Bank, per linear foot	30 Lin. Ft.	\$ _____	\$ _____
P- 11 8-40	Section H Conduit Bank, per linear foot	95 Lin. Ft.	\$ _____	\$ _____
P- 12 8-40	Section I Conduit Bank , per linear foot	108 Lin. Ft.	\$ _____	\$ _____
P- 13 8-40	Connect Existing Ductbank into new Vault, per Each	2 Each	\$ _____	\$ _____
P- 14 8-40	Electronic Tracer Ball, per Each	3 Each	\$ _____	\$ _____

**SubTotal, Group P**

**Unit Bid Item Nos. P-1 through P-14**

\$ \_\_\_\_\_ (6)

10.3% Sales Tax on Power Bid Items

(6) \* 0.103

\$ \_\_\_\_\_ (7)

**Total, Group P**

(6) + (7)

\$ \_\_\_\_\_ (8)

**Contractor's Name:** \_\_\_\_\_

**Specification Number: PW23-0090F ADDENDUM #2**

# ADDENDUM #2

**Group-L: TPU S 17th Street Court D/E Project  
Lump Sum Bid Items L-1 through L-13  
Specification No. PW23-0090F ADDENDUM#2**

ITEM NO.	ITEM DESCRIPTION	ESTIMATE QUANTITY	UNIT PRICE	TOTAL AMOUNT
L- 1 1-05	Project Red Line Drawings	1 Lump Sum	LUMP SUM	\$
L- 2 1-07	SPCC Plan	1 Lump Sum	LUMP SUM	\$
L- 3 1-09	Mobilization	1 Lump Sum	LUMP SUM	\$
L- 4 1-10	Pedestrian Traffic Control	1 Lump Sum	LUMP SUM	\$
L- 5 1-10	Project Temporary Traffic Control	1 Lump Sum	LUMP SUM	\$
L- 6 2-06	Subgrade Maintenance and Protection	1 Lump Sum	LUMP SUM	\$
L- 7 2-17	Site Health and Safety Plan	1 Lump Sum	LUMP SUM	\$
L- 8 2-17	Site Health and Safety Officer	1 Lump Sum	LUMP SUM	\$
L- 9 2-17	Soil Management Plan	1 Lump Sum	LUMP SUM	\$
L- 10 8-01	Erosion Control and Water Pollution Prevention	1 Lump Sum	LUMP SUM	\$

Contractor's Name: \_\_\_\_\_

Specification Number: PW23-0090F ADDENDUM #2

# ADDENDUM #2

ITEM NO.	ITEM DESCRIPTION	ESTIMATE QUANTITY	UNIT PRICE	TOTAL AMOUNT
L- 11 8-01	Stormwater Pollution Prevention Plan (SWPPP)	1 Lump Sum	<u>LUMP SUM</u>	<u>\$</u>
L- 12 8-02	Roadside Restoration	1 Lump Sum	<u>LUMP SUM</u>	<u>\$</u>
L- 13 8-21	Permanent Signing	1 Lump Sum	<u>LUMP SUM</u>	<u>\$</u>

**Total, Group L**  
**Bid Item Nos. L-1 through L-13** \$ \_\_\_\_\_ (9)

Contractor's Name: \_\_\_\_\_

Specification Number: PW23-0090F ADDENDUM #2

Group L, Page 2 of 2

# ADDENDUM #2

## BID TOTALS SUMMARY, ADDENDUM #2:

GROUP R: Roadway Bid Items

GROUP R TOTAL \$ \_\_\_\_\_ (5)

GROUP P: Power Bid Items

GROUP P SUB TOTAL (excluding sales tax) \$ \_\_\_\_\_ (6)

GROUP L: Lump Sum Bid Items

GROUP L TOTAL \$ \_\_\_\_\_ (9)

TOTAL BASE BID (5) + (6) + (9) \$ \_\_\_\_\_  
Excluding sales tax

---

---

Contractor's Name: \_\_\_\_\_  
Specification Number: PW23-0090F ADDENDUM #2  
TPU S 17th Street Court D/E Project

# ADDENDUM #2

---

---

## Proposal for Incorporating Recycled Materials into the Project

In compliance with RCW 70A.205.700, the Bidder shall propose below, the total percent of construction aggregate and concrete materials to be incorporated into the Project that are recycled materials. Calculated percentages must be within the amounts allowed in Section 9-03.21(1)E, Table on Maximum Allowable Percent (By Weight) of Recycled Material, of the Standard Specifications.

Proposed total percentage: \_\_\_\_\_ percent.

*Note: Use of recycled materials is highly encouraged within the limits shown above, but does not constitute a Bidder Preference, and will not affect the determination of award, unless two or more lowest responsive Bid totals are exactly equal, in which case proposed recycling percentages will be used as a tie-breaker, per the APWA GSP in Section 1-03.1 of the Special Provisions. Regardless, the Bidder's stated proposed percentages will become a goal the Contractor should do its best to accomplish. Bidders will be required to report on recycled materials actually incorporated into the Project, in accordance with the APWA GSP in Section 1-06.6 of the Special Provisions.*

Bidder: \_\_\_\_\_

Signature of Authorized Official: \_\_\_\_\_

Date: \_\_\_\_\_

---

---